

Section II.

TM 9-2815-210-34P

7 —

8 thru 20

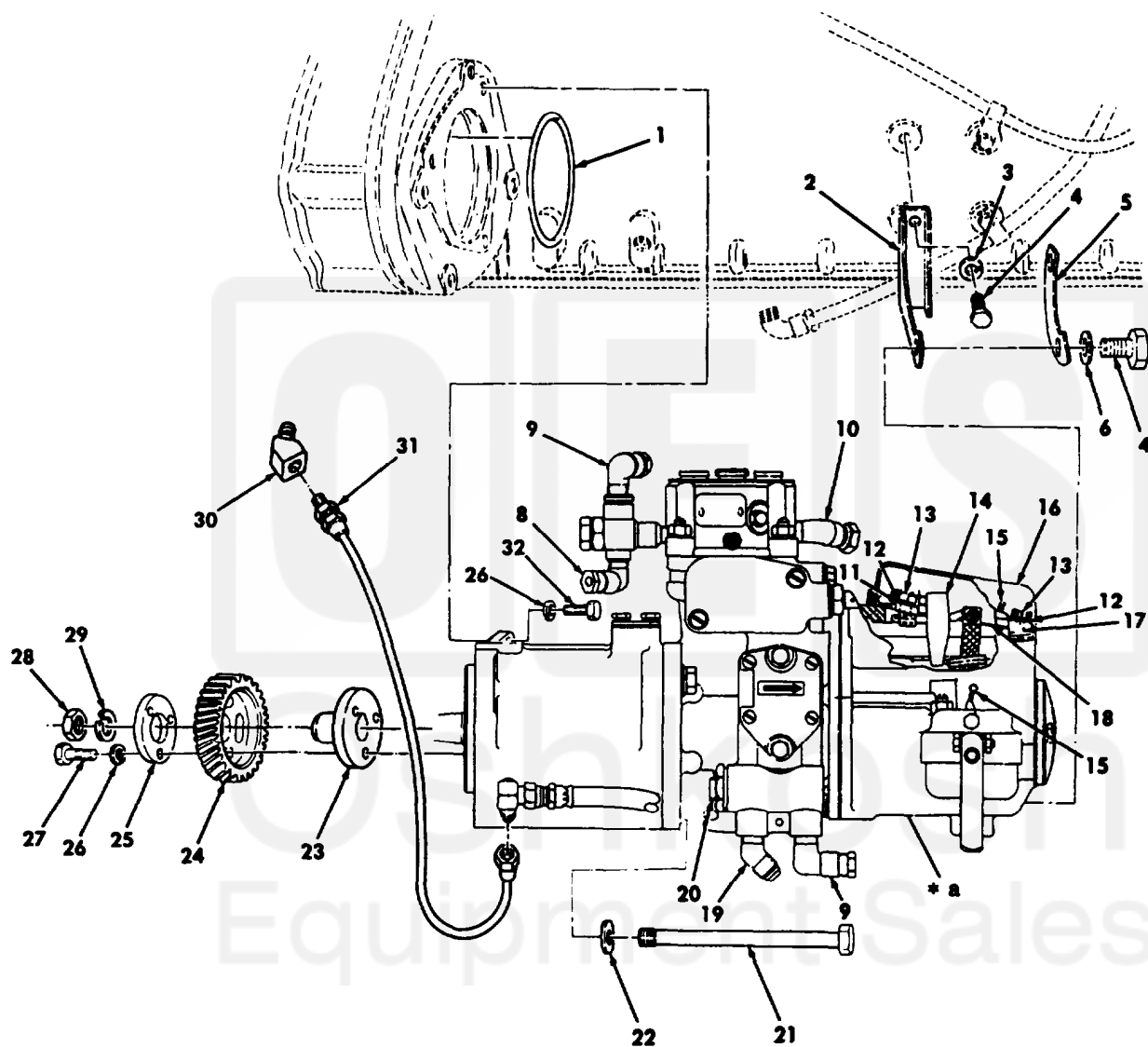

* a PART OF ITEM 7

Figure 23. Fuel Injector Pump, Driven Gear, and Related Parts.

SECTION II		TM9-2815-210-34P				
(1)	(2)	(3)	(4)	(5)	(6)	(7)
ITEM NO	SMR CODE	NSN	CAGEC	PART NUMBER	DESCRIPTION AND USABLE ON CODES(UOC)	QTY
GROUP 0302 FUEL INJECTOR						
FIG. 23 FUEL INJECTION PUMP, DRIVEN GEAR, AND RELATED PARTS						
1	PAFZZ	5331005821560	96906	MS28775-235	O-RING PART OF KIT P/N 57K1319	1
2	PAFZZ	5340001781362	19207	10912553	BRACKET,ANGLE	1
3	PAFZZ	5310009594679	96906	MS35340-45	WASHER,LOCK	2
4	PAFZZ	5306002258496	96906	MS90725-31	BOLT,MACHINE	4
5	PAFZZ	5340001015600	19207	11610207	LOCKING PLATE,NUT A	1
6	PAFZZ	5310001940636	96906	MS9320-11	WASHER,FLAT	2
7	PGFHH	2910001168241	01843	KT9073-3	PUMP,FUEL,METERING SEE TM9-2910-226-34P FOR REPAIR PARTS	1
8	PAHZZ	4730008828622	11083	3B9053	.ELBOW,PIPE TO TUBE PART OF KIT P/N 57K1320	1
9	PAHZZ	4730002032866	19207	10951182	.ELBOW,PIPE TO TUBE	2
10	PAHZZ	4730009018129	19207	10951181	.ELBOW,PIPE TO TUBE	1
11	KFHZZ		19207	12380107	.WASHER, FLAT PART OF KIT P/N 57K1320	2
12	PAHZZ	5310006825930	96906	MS35340-44	.WASHER,LOCK PART OF KIT P/N 57K1320	6
13	PAHZZ	5306002984176	63005	6738112	.BOLT,MACHINE PART OF KIT P/N 57K1320	6
14	KFHZZ		19207	12380106	.PLATE,VALVE STOP PART OF KIT P/N 57K1320	1
15	KFFZZ		19207	12380081	.SEAL,ANTIPILFERAGE PART OF KIT P/N 57K1320	2
16	KFHZZ		19207	12380108	.COVER PART OF KIT P/N 57K1320	1
17	PAHZZ	5340009115754	19207	10896235	.CLAMP,LOOP	1
18	PAHZZ	5330003106556	01843	GA908	.GASKET PART OF KIT P/N 57K1319 PART OF KIT P/N 57K1320	1
19	PAHZZ	4730006400261	81343	6-4 070302BA	.ELBOW,PIPE TO TUBE PART OF KIT P/N 57K1320	1
20	PAHZZ		19207	12380049	.REDUCER, PIPE	1
21	PAHZZ	5306007289959	19207	10935554	BOLT,SELF-LOCKING	1
22	PAFZZ	5310000806004	96906	MS27183-14	WASHER,FLAT	1
23	PAFZZ	3010009667393	19207	10935240	COUPLING HALF,SHAFT	1
24	PAFZZ	3020003138543	19207	10935218	GEAR,HELICAL PART OF KIT P/N 5702680	1
25	PAFZZ	5365008600571	19207	10889762	SPACER,BLOCK	1
26	PAFZZ	5310009594675	96906	MS35340-46	WASHER,LOCK	5
27	PAFZZ	5305002693237	80204	B1821BH038F113N	SCREW,CAP,HEXAGON H	3
28	PAFZZ	5310004910319	19207	10898716	NUT,PLAIN,HEXAGON	3
29	PAFZZ	5310001670680	96906	MS35338-49	WASHER,LOCK	1
30	PAFZZ	4730002775683	96906	MS14307-1	ELBOW,PIPE	1
31	PAFZZ	4720000814212	19207	10912423	HOSE ASSEMBLY,NONME	1
32	PAFZZ	5305005432419	80204	B1821BH038C113N	SCREW,CAP,HEXAGON H	2

END OF FIGURE